

1 2 3 4 5 6 7 8

BILL OF MATERIAL					
ITEM	QTY	PART NUMBER	DESCRIPTION	MATERIAL	VENDOR
1	1	6810001	XY TO FOCALPLANE ADAPTER PLATE	6061 T-6 ALUMINUM	

NOTES: UNLESS OTHERWISE SPECIFIED
1. NEXT ASSEMBLY: 6810000

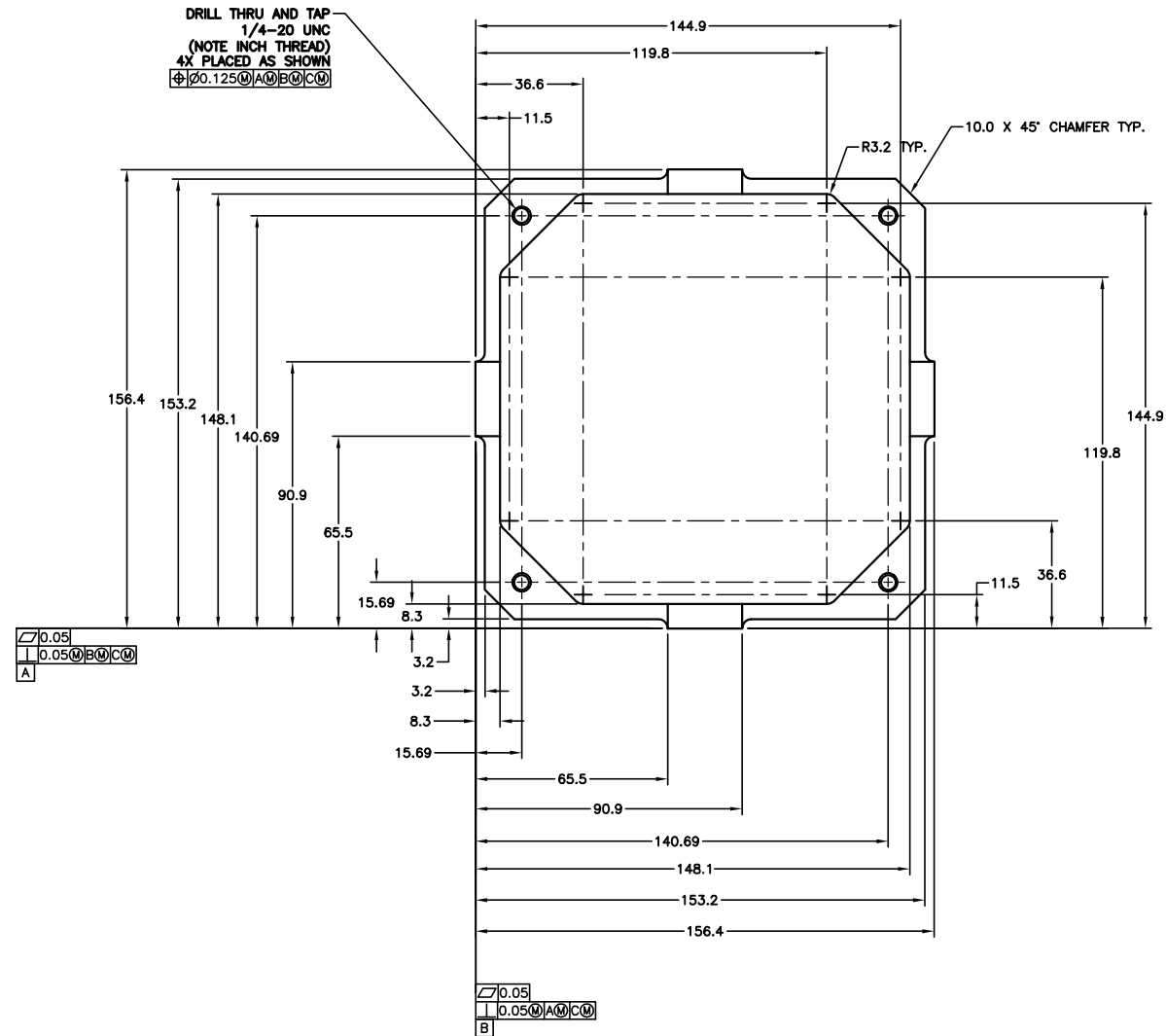
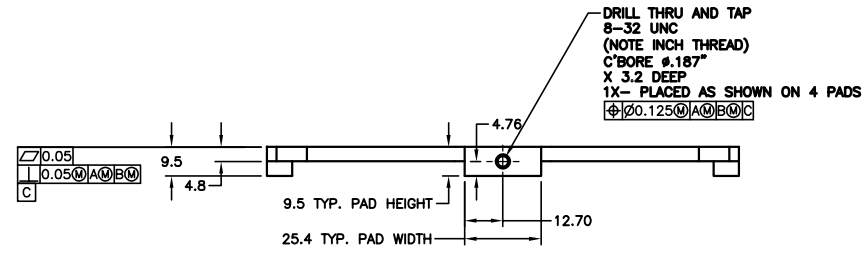
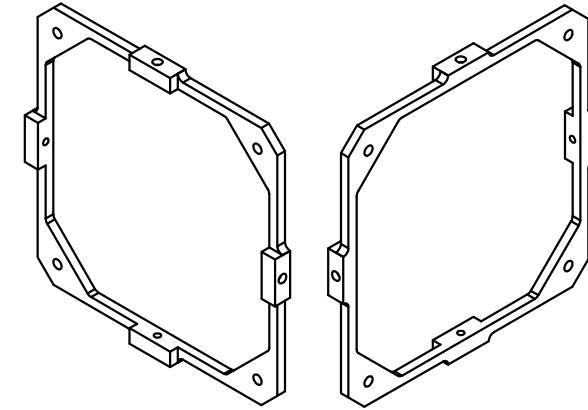

IN MILLIMETERS UNLESS OTHERWISE SPECIFIED TOLERANCES: F. ± 0.5 M. ± 0.1 H. ± 0.05 L. ± 0.02 ANGLE ± 0.5° SURFACE FINISH: 125 - 1.6μm - 63μm EDGE BREAK: 0.3mm x 45°		OBSERVATORIES OF THE CARNEGIE INSTITUTE OF WASHINGTON 813 SANTA BARBARA ST. PASADENA, CA 91101 INAMORI MAGELLAN AREAL CAMERA AND SPECTROGRAPH PROJECT: IMACS DEWAR TITLE: FOCALPLANE SUBASSEMBLY XY TO FOCALPLANE ADAPTER PLATE	
PROJECTOR: 	DATE: 08/08	SCALE: 2/1	Dwg. No.: 6810001

B		REVIEWED AND ISSUED	TSH	01/08/08
REVISION	ZONE	DESCRIPTION OF REVISION	BY	DATE